



Chrysler 360 LA & Magnum

317-862-3724
www.IndyHeads.com
info@IndyHeads.com



**360 Magnum
Crate Engine**
380 HP
415 Torque
\$5,363.00
with New MA-X Heads
As Pictured
\$4,863.00
with New OEM Heads
325 HP

- Dyno ran - be here to watch
- Indy MA-X Heads 1.92 x 1.625
- Porting - 9.5 to 1 Compression
- Crane Hydraulic Roller Cam
- M.P. 017 Single Plane Intake

- Aluminum 8 Blade Pump & Cover
- Orange Box Rest & Harness
- 600 CFM Edelbrock
- Magnum Black Valve Covers



**408 Magnum
Crate Engine**
430 HP
480 Torque
\$7,125.00
with New MP-AL Heads
\$7,625.00
with New MA-X Heads
460HP
As Pictured

- Dyno ran - be here to watch
- Aluminum Mopar Magnum Heads
- CNC Porting - 9.5 to 1 Compression
- Crane Hydraulic Roller Cam
- M.P. 017 Single Plane Intake

- Aluminum 8 Blade Pump & Cover
- Orange Box Rest & Harness
- 750 CFM Edelbrock
- Magnum Black Valve Covers



**415 Magnum
Crate Engine**
520 HP
500 Torque
\$8,345.00
As Pictured
Magnum Mod Man 6-Pack
add \$770.00

- Dyno ran - be here to watch
- Indy MA-X Heads w/ Port Work
- 2.055x1.60 Long Valves 1.900 Height
- 10 to 1 Compression Forged Pistons
- Comp Hyd Roller .580/.578 236/.242

- Indy Magnum Mod Man Intake 2x4
- 500 CFM Edelbrock Carbs
- Magnum Black Valve Covers
- Mopar Electronic Dist. / ICH Wires
- Orange Box Rest & Harness

Callies Small Block Crankshaft



340-613 4.25 Stroke x 2.1 Pin 340-4340 **\$1,495**

Eagle Crankshafts

360-593 4.00 Stroke x 2.125 Pin 340 Cast **\$425**
360-594 4.00 Stroke x 2.125 Pin 360 Cast **\$425**
360-596 4.00 Stroke x 2.125 Pin 340-4340 **\$75 0**
360-598 4.00 Stroke x 2.125 Pin 360-4340 **\$75 0**



Eagle Rods Small
Block Mopar SIR **\$299**
(I-Beam)
Small Block Mopar 3-D **\$499**
(H-Beam)
Rods are 6.123 with .984 Pin



Complete overhaul gasket set for LA 340/360
P4120692 **\$75.00**

Manifolds



Edelbrock intakes have been original equipment on many Chrysler cars. Buy the best of the best.

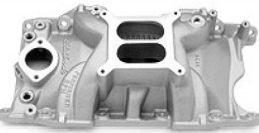

360 Air-Gap Dual Plane
7576 340/360 Air-Gap Performer RPM 1500-6500 **\$325.00**
7577 Magnum Air-Gap Performer RPM 1500-6500 **\$350.00**

340/360 4 Barrel Single Plane
2915 340/360 Victor 3500-8000 **\$350.00**
2815 340/360 Super Victor 3500-8000 **\$375.00**

Six Pack Intake
340/360 Original TA 6 Pack Intake 2500-6500 RPM P4529054 **\$335.00**



Indy Small Block Manifolds

360-3 4150 Single Plane (Fits 360-2 Heads and Oval Port W2) **\$399**
360-3R 4150 Single Plane (Fits 360-1 Heads and Rect. Port) **\$399**
360-3M 4150 Single Plane (Fits any Magnum Style Head) **\$399**

OVER STOCK SALE!

Rings, Bearings, Pistons, Cam Bearings, Heads



Standard Cam Bearing for LA or Magnum Block **\$20.00**
60MM Roller Cam Bearings for 48 Degree R-Block **\$85.00**
360 Main Bearings 1266P .010 and .020 **\$25.00**
360 Rod Bearings 481P .010 **\$25.00**
360 LA Hyper Pistons, 4.020 Bore Stock Stroke - Coated Skirts **\$199.00**
360 Magnum Hyper .50MM Over Stock Stroke - Coated Skirts with Rings **\$199.00**
402 LA Stroker Cast Pistons, 4.00 Stroke, 4.00 / 4.020 **\$199.00**
440 Cast 8 to 1 Pistons 4.320 Std. Bore **\$199.00**
440 4.320 Ring Set 5/64 **\$55.00**

Mopar W9 Heads

Bronze Guides, CNC Chambers & Bowls, 2.150 x 1.600 Valve Job, 59 Degree Push Rod Clearance.

\$1,000.00 Per Pair
\$1,200.00 With Valves

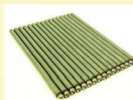

Magnum Small Block Pushrods \$20
Fits Magnum block/roller lifters & Magnum heads w/ stock Magnum rockers (set of 16)

Hi Strength Double Roller Timing Chain & Sprocket

Fits Small Block & Magnum 1-keyway 3-160S **\$29.95**

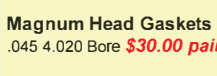

Magnum Head Gaskets
.045 4.020 Bore **\$30.00 pair**



Cometic Head Gaskets Pair
Small Block 4.125/.040 **\$198**
Small Block 4.200/.040 **\$198**
R3 4.200/.051 (360-1) **\$198**
Custom Sizes Available



Small Block Sheet Metal Valve Covers LA
360-7 Plain **\$383.00**
360-7 Indy Logo **\$383.00**



SB Valve Cover Gasket LA
Extra Thick 5/16 Helps with Rocker Clearance #280 **\$5 0.00**

Small Block Rotating Kits



408-415" 360 Small Block
Eagle Cast 4.00 Crank, Eagle SIR I-beam Rods, Wiesco Forged Coated Pistons (Flattop or Dish), Rings and Bearings Available
in 4.030, 4.060, 4.070 Bore **\$1,875.00**
Eagle Steel 4.00 Crank Add \$325
Eagle H-beam Rods Add \$210
Labor To Internally Balance \$250.00

422-426" Small Block With Eagle Crank

Eagle Steel 4.00 Crank, 340 Mains, Eagle H-beam Rods, Diamond Pistons, Rings and Bearings
4.100 Bore **\$2,995**
Labor to Internally Balance Add \$350

440" Small Block With Eagle Crank

Eagle Steel 4.00 Crank, 340 Mains, Eagle H-beam Rods, Diamond Pistons, Rings and Bearings
4.185 Bore **\$3,095.00**
Labor to Internally Balance Add \$350.00

422-440" Small Block With Callies Crank



Callies 4.00/2.1 Crank, 340 Mains, Callies H-Beam Rods, Diamond Pistons, Rings and Bearings **\$2,850.00**
For 440" Add \$150
Labor To Internally Balance Add \$350

Rockers & Rocker Parts

Aluminum Roller Rockers for LA heads, roller tip with aluminum body, fully adjustable.



360-R4-4SR-1.5 1.5 Ratio **\$365.00**
360-R4-4SR-1.6 1.6 Ratio **\$365.00**

Heavy Duty Rocker Shafts for Stock or Aluminum Rollers

360-R4-14 **\$105.00**



Small Block Electric Water Pump
Meziere 35 GPM Electric Water Pump with backplate. **\$550.00**

426" Bracket Engine

725 HP 600 Torque



\$15,795.00
As Pictured

- R3 Waterblock - 9.560 Deck - 4.125 Bore
- Eagle 4.00 Crank & H-Beam Rods - Internal Balance
- 360-1 CNC 245 Heads 2.10 x 1.65 - 63 cc - 14 to 1
- R-2 Roller Cam .660 Lift - .275/.284 - Comp Lifters
- Indy 360-2 Intake 1x4 - Holley 950 CFM Carb
- T&D Rockers - Indy Oiling System - ATI Balancer
- MSD Distributor and ICH Wires - Sheet Metal V-Covers

A-Engine Cam & Lifter Kits



*****On sale while supplies last*****

Magnum Small Block Hydraulic Roller. Works with mechanical fuel pump. 440/430 204/208 HR112 Idle - 4700 rpm; Cam Only Magnum Block **\$295**
Magnum Small Block Crane Hydraulic Roller. For EFI or carb with electric fuel pump. .467/.482 .208/.216 HR112 Idle - 5600 rpm; Cam Only Magnum Block **\$295**
Magnum Hydraulic Roller Lifters Set of 16 with yokes Fits Magnum Blocks (Lifters and Yokes Only) **\$195**
LA Small Block Hydraulic Flat Tappet. .508/.508 .248/.248 H108 Idle - 6500 rpm; Cam Only fits LA Block **\$99**



| Part # | Lift | Duration @ .050 | CntrlIn | Price |
|------------|-----------|-----------------|---------|---------------------|
| CL20-208-2 | .425/.425 | 252/252 | 212/212 | 110 \$185.00 |
| CL20-210-2 | .440/.440 | 260/260 | 212/212 | 110 \$185.00 |
| CL20-212-2 | .454/.454 | 268/268 | 218/218 | 110 \$185.00 |
| CL20-223-3 | .477/.480 | 260/280 | 224/230 | 110 \$210.00 |
| CL20-224-4 | .498/.491 | 274/286 | 230/236 | 110 \$216.00 |

Comp Cams Hydraulic Roller Thumper Series
Muscle Car sound & Performance in Retro Fit Hydraulic Roller
20-600-9 .513/.498 283/303 227/241 107 **\$335.00**
20-601-9 .522/.509 291/311 235/249 107 **\$335.00**
20-603-9 .533/.519 299/319 243/257 107 **\$335.00**
8620-16 Retro Fit Hydraulic Roller Lifters **\$545.00**



Fuel Pump Block-Off Plate
440-C2-408CVR Blue Anodized Billet **\$35.00**
440-C2-408 Chrome Mopar Logo **\$15.00**